

## 60" SAFE STEPS

### Parts Description

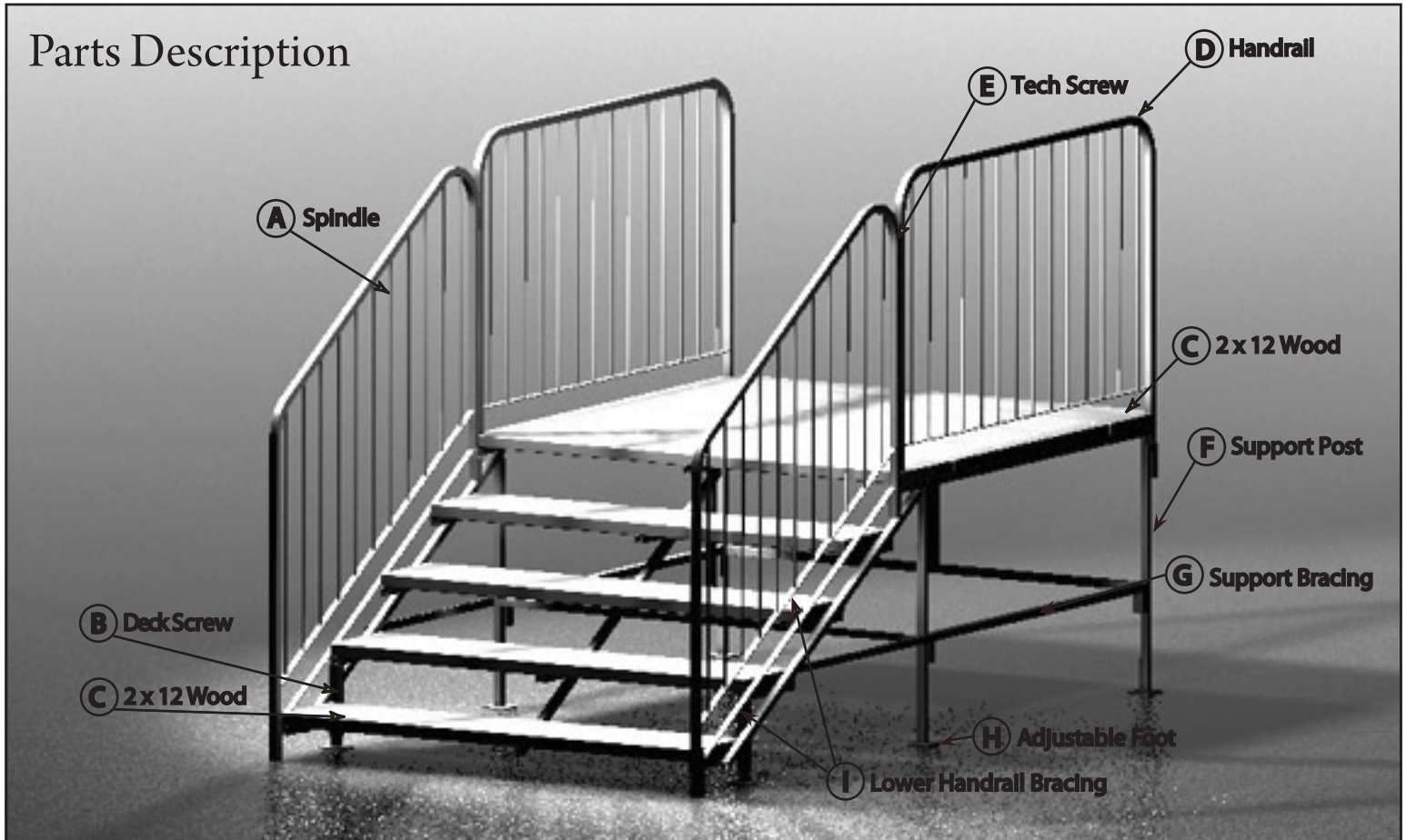

### Bill of Materials

A. 1/4" Round Stock
B. #14 x 2-1/4" Deck Screws
C. 2" x 12" x 60" (nominal) #2 Pine
D. 1" x 1" x 16 GA
E. #12 x 3/4" Tech Screws
F. 1-1/4" x 1-1/4" x 14 GA
G. 1-1/4" x 1-1/4" x 14 GA
H. 3/4" x 3/4" x 16 GA w/ 3" x 3" Plate
I. 3/4" x 1/8" Flat Stock

# 60" SAFE STEPS

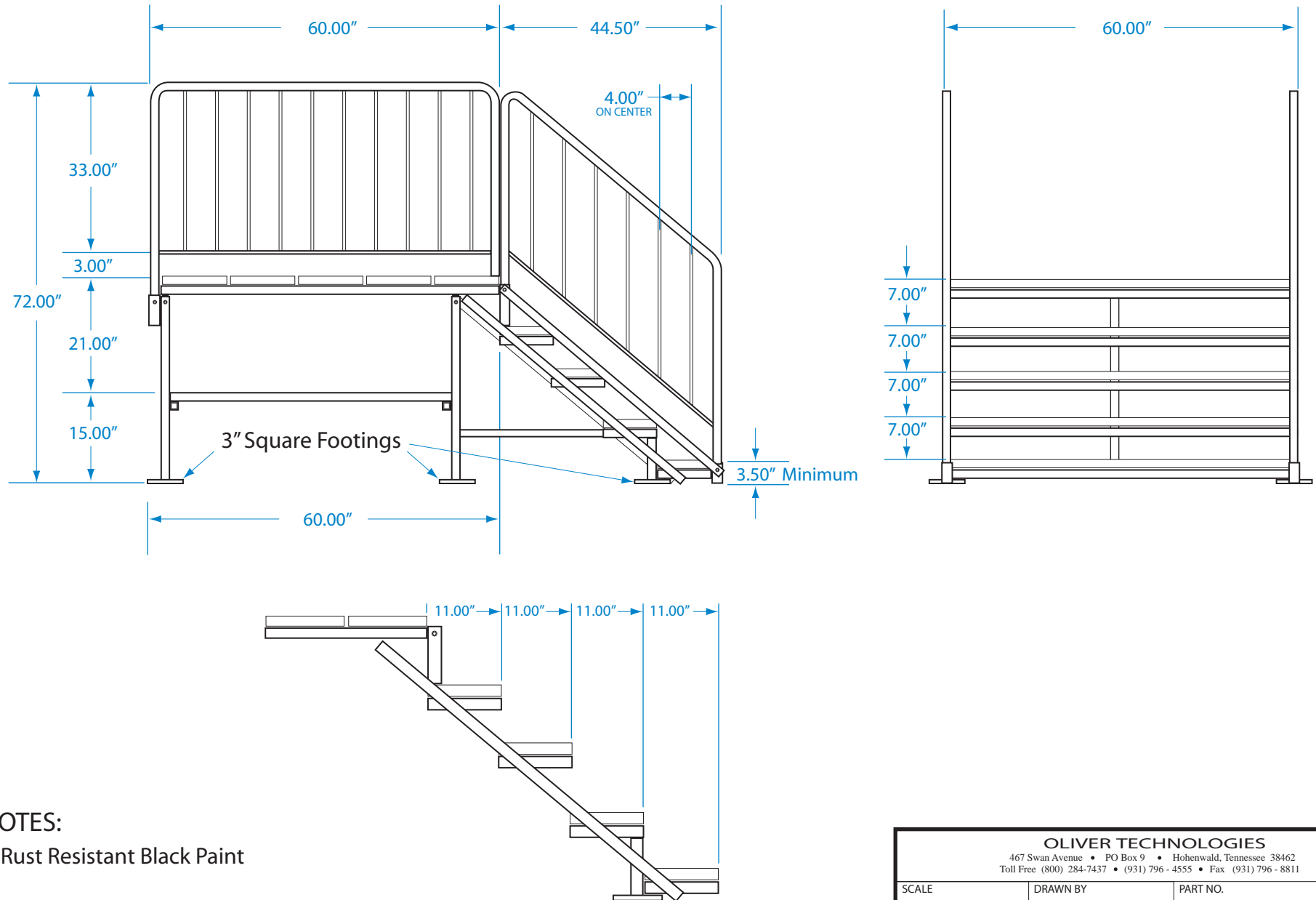

## NOTES:

Rust Resistant Black Paint

<b>OLIVER TECHNOLOGIES</b> 467 Swan Avenue • PO Box 9 • Hohenwald, Tennessee 38462 Toll Free (800) 284-7437 • (931) 796 - 4555 • Fax (931) 796 - 8811		
SCALE	DRAWN BY	PART NO.
NOT TO SCALE	SLM 5-23-11	60SAFESTEPS
SHEET	MATERIAL	DESCRIPTION
1 OF 1	PAINTED STEEL	60" Wood/Metal Steps